

Part 1

Keep Moving, Keep Growing...





VALVE ASSY, PLUNGER SECTION
67603-25080-71



VALVE ASSY, PLUNGER SECTION
67601-15460-71



VALVE ASSY, PLUNGER SECTION
67606-23330-71



VALVE ASSY, PLUNGER SECTION
67604-16560-71



BOOT, LEVER
53233-23320-71



KNOB, LEVER
67809-25080-71



LEVER SUB-ASSY. NO. 3
67804-26530-71



LEVER SUB-ASSY. NO. 4
67806-26530-71



LEVER SUB-ASSY. NO. 5
67808-26530-71



LEVER SUB-ASSY. NO. 3

67803-15460-71



ROD SUB-ASSY.

67807-26530-71



ROD SUB-ASSY.

67807-13130-71



BOLT

67894-26530-71



BOLT

67895-26530-71



BOLT

67896-26530-71



PLUG

53235-23320-71

53235-23321-71



FITTING

90407-13015-71



FITTING

90407-13014-71



PIN

90240-08008-71
47116-23010-71



PIN

90240-05003-71

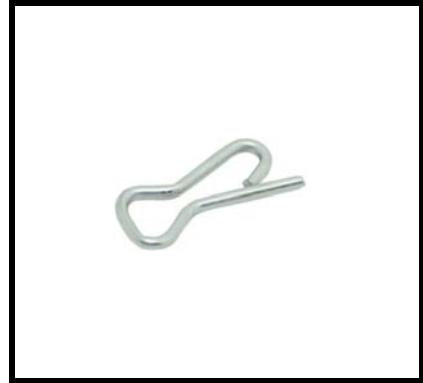

CLIP

90468-14001-71

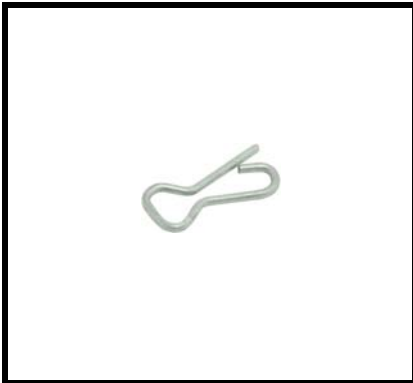

CLIP

67827-23320-71



BUSHING

31327-23000-71



SWITCH ASSY, LIMIT

57460-13200-71



SWITCH SUB-ASSY

67833-23320-71
53235-23321-71



BOOT

67831-23321-71
90386-13001-71



CYLINDER ASSY, TILT

65520-U2201-71



RADIATOR ASSY.

16410-U2201-71

16420-U1280-71



RADIATOR ASSY.

16410-U2201-71

16420-U1280-71



RADIATOR ASSY.

16460-26610-71

16420-F2180-71



RADIATOR ASSY.

16460-26610-71

16420-F2180-71



PUMP ASSY, WATER

16110-78156-71



PUMP ASSY, WATER

16110-78206-71



COVER ASSY, WATER PUMP

16120-76001-71



COVER ASSY, WATER PUMP

16120-78151-71



PUMP ASSY, WATER

16100-78205-71

16100-78206-71



PUMP ASSY, WATER
16100-78156-71
16100-78157-71



PAD, PEDAL
31319-20540-71



PAD, PARKING PEDAL
46165-26660-71
46165-U2230-71



GAGE SUB-ASSY, OIL LEVEL
32604-26610-71



GAGE SUB-ASSY, OIL LEVEL
32392-30520-71



CYLINDER ASSY, MASTER
47530-U2100-71



CYLINDER ASSY, MASTER
47210-23321-71
47210-U2170-71



CYLINDER ASSY, WHEEL
47410-32500-71
47410-U2130-71



CYLINDER ASSY, WHEEL
47410-20540-71
47410-U2100-71



CYLINDER ASSY, WHEEL

47410-10480-71

47410-11630-71



CYLINDER ASSY, WHEEL

47410-23420-71

47410-U2170-71



PIN

43731-23442-71



COLLAR

43735-23440-71

47410-11630-71



COLLAR

43735-13310-71

47410-U2170-71



PIN

43731-13310-71

43731-13311-71



TIE-ROD

43751-23440-71



TIE-ROD

43752-23442-71



PLATE, STOPPER

43753-13310-71

43753-13311-71



SHOE SUB-ASSY

47403-12810-71



SHOE SUB-ASSY

47404-12810-71



SHOE SUB-ASSY

47405-12810-71



SHOE SUB-ASSY

47512-33060-71



SHOE SUB-ASSY

47513-33060-71



SHOE SUB-ASSY

47514-33060-71



SHOE SUB-ASSY

47405-23600-71



PULLEY

68804-25160-71



PULLEY

68855-25150-71

68804-25080-71



BLUE SAFETY LIGHT, 9-80V
410BLU980



WORK LIGHT, 9-80V
RO980



WORK LIGHT, 9-80V
SQ980



LAMP ASSY, HEAD
56510-N3070-71



LAMP ASSY, FRONT COMBINATION
56610-N3070-71



LAMP ASSY, REAR COMBINATION
56620-N3070-71



LAMP ASSY, REAR COMBINATION
56630-N3070-71
56630-U3610-71



LAMP ASSY, REAR COMBINATION
56640-N3070-71
56640-U3610-71



COVER
56651-N3170-71
56651-U3610-71



LAMP ASSY, WARNING
STR126
12-110V



LAMP ASSY, WARNING
STR126LED
12-110V, LED



WORK LIGHT, 9-80V
SQ980-27W



LAMP ASSY, WARNING
STR125
12-110V



LAMP ASSY, WARNING
STR125LED
12-110V, LED



LAMP ASSY, WARNING
STR127
12-110V



MIRROR SUB-ASSY, BACK
58720-23320-71



ANTI-BLIND SPOT DOME MIRROR
DM112



ANTI-BLIND SPOT DOME MIRROR
DM113



ELEMENT SUB-ASSY, CYCLONE AIR CLEANER

17743-U2230-71
17743-23600-71



ELEMENT SUB-ASSY, CYCLONE AIR CLEANER

17744-U2230-71
17744-23600-71



ELEMENT SUB-ASSY, CYCLONE AIR CLEANER

17741-U2100-71



ELEMENT SUB-ASSY, CYCLONE AIR CLEANER

17741-U3330-71



ELEMENT SUB-ASSY, CYCLONE AIR CLEANER

17744-U3330-71
17742-30510-71



ELEMENT SUB-ASSY, CYCLONE AIR CLEANER

16546-FJ170
91B61-00912



STARTER ASSY

28100-20553-71
28100-U2100-71



ALTERNATOR ASSY

27060-78156-71



PIN, STEERING KNUCKLE KING

43232-U3271-71



SEAT ASSY.
US-01



SEAT ASSY.
US-02



SEAT ASSY.
US-03



SEAT ASSY.
US-04



CUSHION ASSY
53715-23321-71
53727-23321-71



ALARM
ALA125
12-80V



HORN ASSY
58120-23470-71



TERMINAL ASSY
80982-76049-71



TERMINAL ASSY
80982-76014-71



BEARING

00590-05129-71

14121-13400-71



BEARING, INNER

97600-32209-71

43222-U2170-71



BEARING, OUTER

97600-30306-71



ROLLER, LIFT

61236-23601-71

61236-U2101-71



ROLLER, LIFT

61236-13601-71

63358-U1100-71



INSULATOR

17417-23600-71



RUBBER, MOUNTING

16551-23470-71



CUSHION

16415-23000-71



SPACER

16416-23000-71



BOX, INSTRUMENT PANEL

53215-23321-71



PAD, STEERING WHEEL

45121-12471-71

45121-12472-71



BUSHING, MAST SUPPORT

76149-10110-71



CLAMP

17402-23600-71



CLAMP SUB-ASSY

23705-23001-71

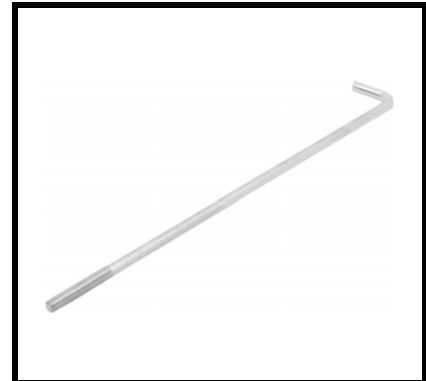

BOLT

28852-23320-71



BUSHING

61192-26600-71



BOLT, HUB

43812-23320-71



NUT, HUB

90179-14001-71



SPRING

23543-23470-71



RUBBER

23545-26600-71



RUBBER

23668-23800-71



WHEEL SUB-ASSY, DISC

44209-23420-71



UPPER BEARING

228782



CHAIN SUB-ASSY.

13506-78001-71



RING, HORN CONTACT

45123-23600-71



CONTACT, HORN

57413-22500-71



BOLT

55881-31700-71



KNUCKLE, STEERING, RH

43211-23471-71



KNUCKLE, STEERING, LH

43212-23471-71



DAMPER, ENGINE HOOD

52210-23320-71



GASKET RING, EXHAUST

90584-43001-71



SEAT ASSY, BACK

53710-13900-71



PAD ASSY

53750-13900-71



COVER, RH

58731-26600-71



COVER, LH

58741-26600-71



HOLDER ASSY, CUP

53215-U2230-71

FORK ARM

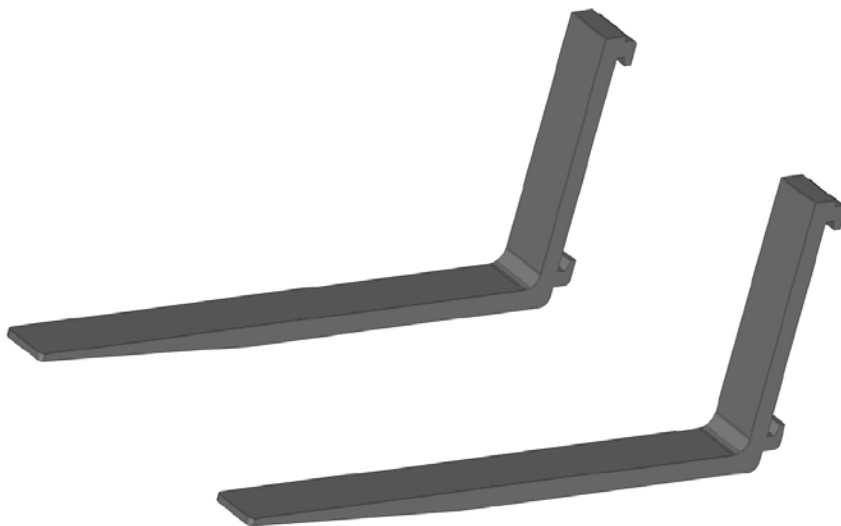

Rolled Bar

CLASS	METRIC MARKET			INCH MARKET		
	CROSS SECTION (MM X MM)		LENGTH (MM)	CROSS SECTION (INCH X INCH)		LENGTH (INCH)
II A (2A)	100	X 40	800-2440	1.5	X 4	30-96
	100	X 45		1.75	X 4	
	125	X 45		1.75	X 5	
III A (3A)	100	X 45	800-2440	1.75	X 4	30-96
	125	X 45		1.75	X 5	
	125	X 50		2	X 5	
	150	X 50	1070-2440	2	X 6	42-96
IV A (4A)	150	X 65	1070-2440	2.5	X 6	42-96
	150	X 70		2.75	X 6	

- 1, Material: 40Cr
- 2, Safety Factor: 3 times
- 3, Mounting dimension conformed to ISO 2328
- 4, Only popular size listed above, please kindly check with us for other sizes.

Welcome to our *New Parts Development Plan* !

*If you have new parts need to develop,
Please kindly finish the sheet below and send to us by fax or email!*

INFORMATION

Company Name:

Contact Person:

Position:

Tel/Email:

OEM P/N	FORKLIFT BRAND	PRODUCT	ESTIMATED ANNUAL VOLUME	TARGET PRICE

"0" RISK, "0" INVESTMENT

- 1, We will get original sample and invest tooling cost to develop.
- 2, We will control the quality and send you FREE sample to check.
- 3, We promise Top Quality and Competitive Price for you.

Part 2 is coming

Keep Moving, Keep Growing...

SHAOXING LIFT BITS MACHINERY CO., LTD.

ADD: NO. 172, GUANHUYAN VILLAGE, QIXIAN TOWN, SHAOXING COUNTY, ZHEJIANG, CHINA.

WEB: WWW.LIFTPARTS.CN

EMAIL: LIFTBITS@GMAIL.COM; INFO@LIFTPARTS.CN;

TEL: +86 (0)575 85663809

FAX: +86 (0)575 85660929